

ONE VERDI PARK

B.9.2

Apartament - 3 camere

SUPRAFATA CONSTRUITA
FARA BALCON

122.80 m²



Nord

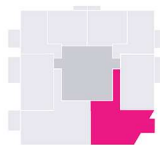

| | |
|--------------|----------------------|
| Hol acces | 19.70 m ² |
| Cameră de zi | 26.50 m ² |
| Bucătărie | 5.50 m ² |
| Spălătorie | 2.00 m ² |
| Dormitor 1 | 13.70 m ² |
| Dormitor M+D | 21.20 m ² |
| Baie M | 5.50 m ² |
| Baie 1 | 4.40 m ² |
| Balcon | 5.20 m ² |

Suprafață utilă
totală (cu terase)

103.70 m²

ambrella[®]
crowdsourcing

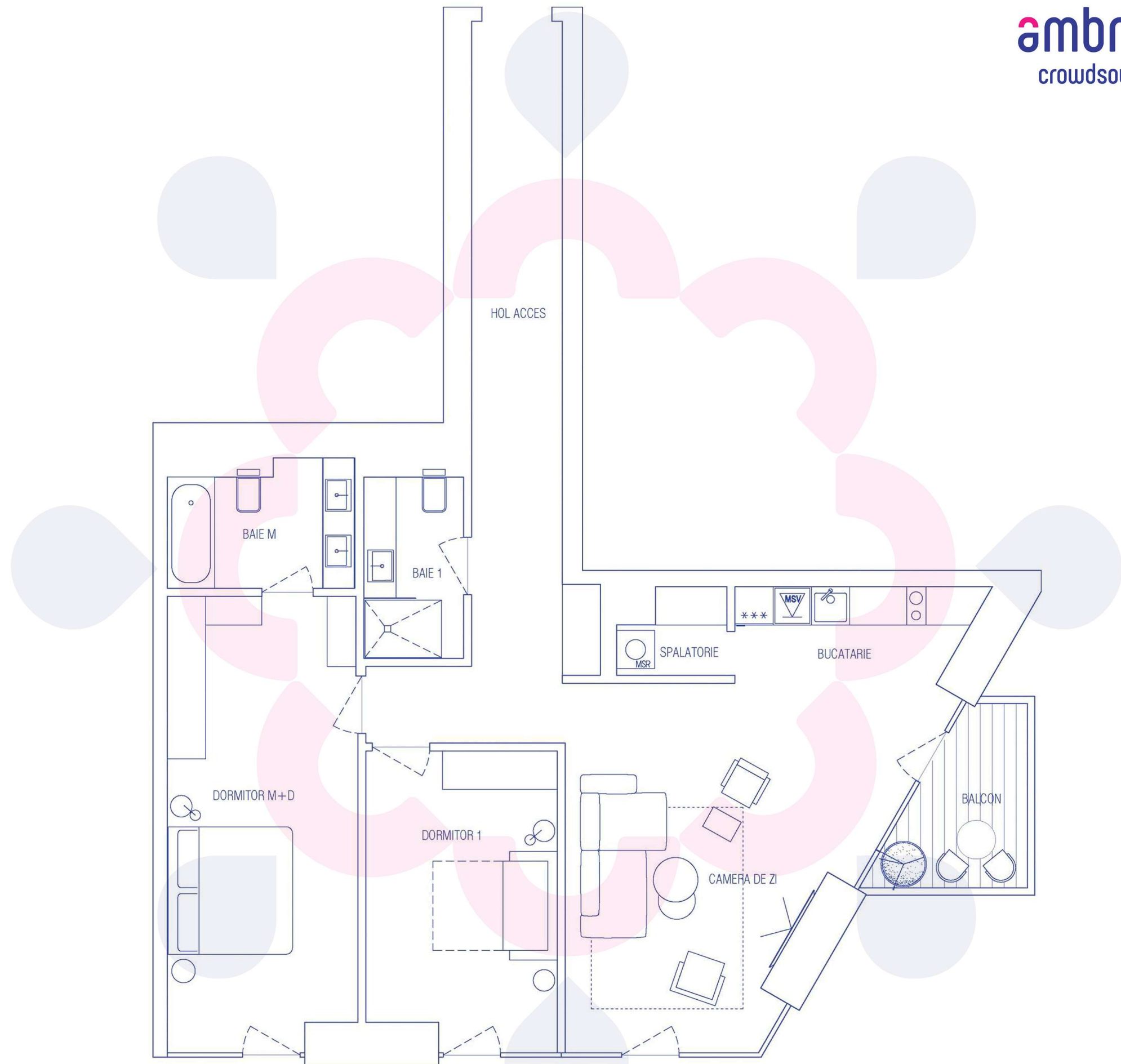

This plan is intended for illustrative purposes only and should be used as a guide to help you visualise the potential of this property and should not be relied upon as the sole determinant of value. While we have taken great care to ensure that all information is as accurate as possible, we cannot be held responsible for any errors, omissions or discrepancies. We encourage you to seek the advice of a professional appraiser or real estate agent before making any decisions based on this plan and to inspect the property personally to ensure that it meets your needs and requirements